

# Alcolizer

TRUSTED ALWAYS

## Product Update

DRUG AND ALCOHOL TESTING SYSTEM FOR INDUSTRY AND ROADSIDE

The Alcolizer LE5 Alcohol tester simply becomes a Drug testing unit with the replacement of a module. Then using an oral fluid sample, the collected sample can be analysed with fast and accurate results on the spot:

- ✓ No risk from visual interpretation by operator
- ✓ Test Time from 2 Minutes
- ✓ Automatic Orientation Sensor
- ✓ Electronic batch calibration chip
- ✓ Temperature monitoring and auto compensation
- ✓ Flow detection and test completion sensing

This system incorporates state of the art Linear Detector Arrays and a patented Optical filtering system that delivers accurate and fast results.



Exchangeable  
Alcohol & Drug  
Modules

OUR SYSTEM DETECTS A VARIETY OF DRUGS SUCH AS:

- Amphetamines
- Benzodiazepines
- THC
- Cocaine
- Methamphetamines
- MDMA
- Opiates
- Phencyclidine



Quality  
ISO 9001  
SAI GLOBAL

Field testing will be completed in Australia late 2016 and Drug Reader Module scheduled for release Q1 2017.

# Druglizer

## Druglizer Cartridge Replacement & Oral Testing

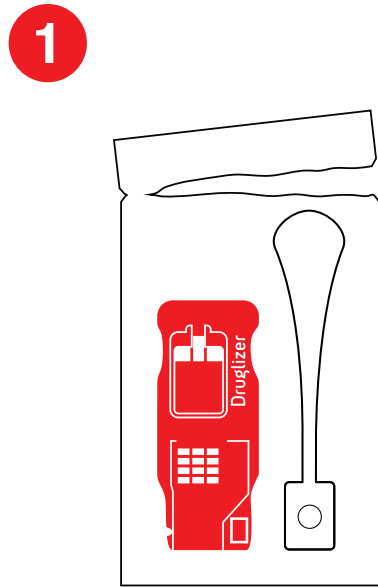

Tear the perforated package that containing the Druglizer cartridge and collector.

Ensure the subject has refrained from consumption of food or beverage for 10 minutes prior to drug test.



Turn the LE5 Drug Reader Module on.

Insert the Druglizer cartridge into the top of the LE5 Drug Reader Module.

The flat area should face back while the area with the collector recess should face towards the front.



Instruct the subject to insert the collector pad into their mouth, moving it side to side so that it touches the sides of their cheeks.

**IMPORTANT** – ensure the subject continues to do this until indicator turns **BLUE**.

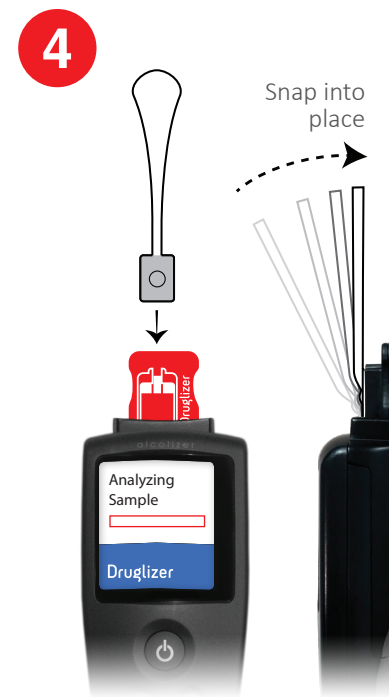

Position collector in an upright position with the oral collection point facing downward.

Insert collector into the Druglizer recess and snap into place.

The LE5 Drug Reader Module will automatically detect the wetted collector and will begin to analyse.



Results will be displayed from 2 minutes.

All results are saved onto the LE5 Drug Reader Module device log and can be displayed on screen or be retrieved later.

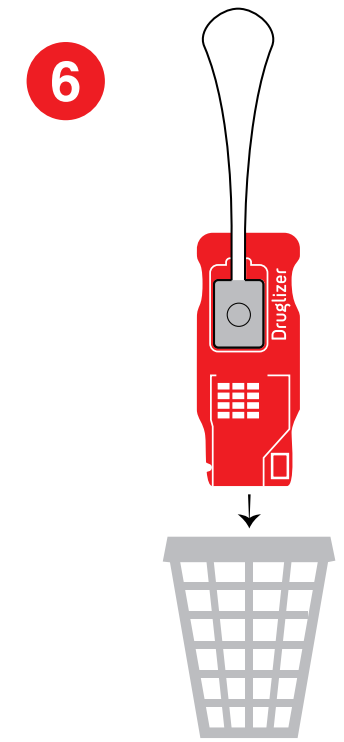

After each test, pull both the cartridge and collector out and dispose of.

The meter will automatically reset and be ready to insert a new Druglizer cartridge.

**Intended use:** Druglizer is intended for screening of drugs of abuse.

**Summary and explanation of function:** Druglizer incorporates state of the art Linear Detector Arrays and a patented Optical Lens filtering system that delivers accurate and fast results.

**Do not use oral collector beyond expiry date printed on package**

**Alcolizer**  
TRUSTED ALWAYS

Phone: 1300 789 908 | Email: sales@alcolizer.com | [www.alcolizer.com](http://www.alcolizer.com)

Druglizer is a trademark of Alcolizer.